



Letter Lok 1800

Channel letter fastening ease with a sleeker modern design clinching machine.

- 18" throat
- Fast cycle times
- Clinch up to 6" deep letters
- Adjustable table
- UL recognized tooling*
- Simple tool adjustment
- Air powered

Designed and built by the industry leaders

*Norlok tooling components MP70001, MP70002 & MP70010. This is standard in all Letter Lok 1800 machines

INNOVATIONS IN ENGINEERING

Letterlok 1800

Specifically designed for making channel letters, the **LL1800** has a wide and expanding tooling portfolio capable of joining industry standard and modern materials.

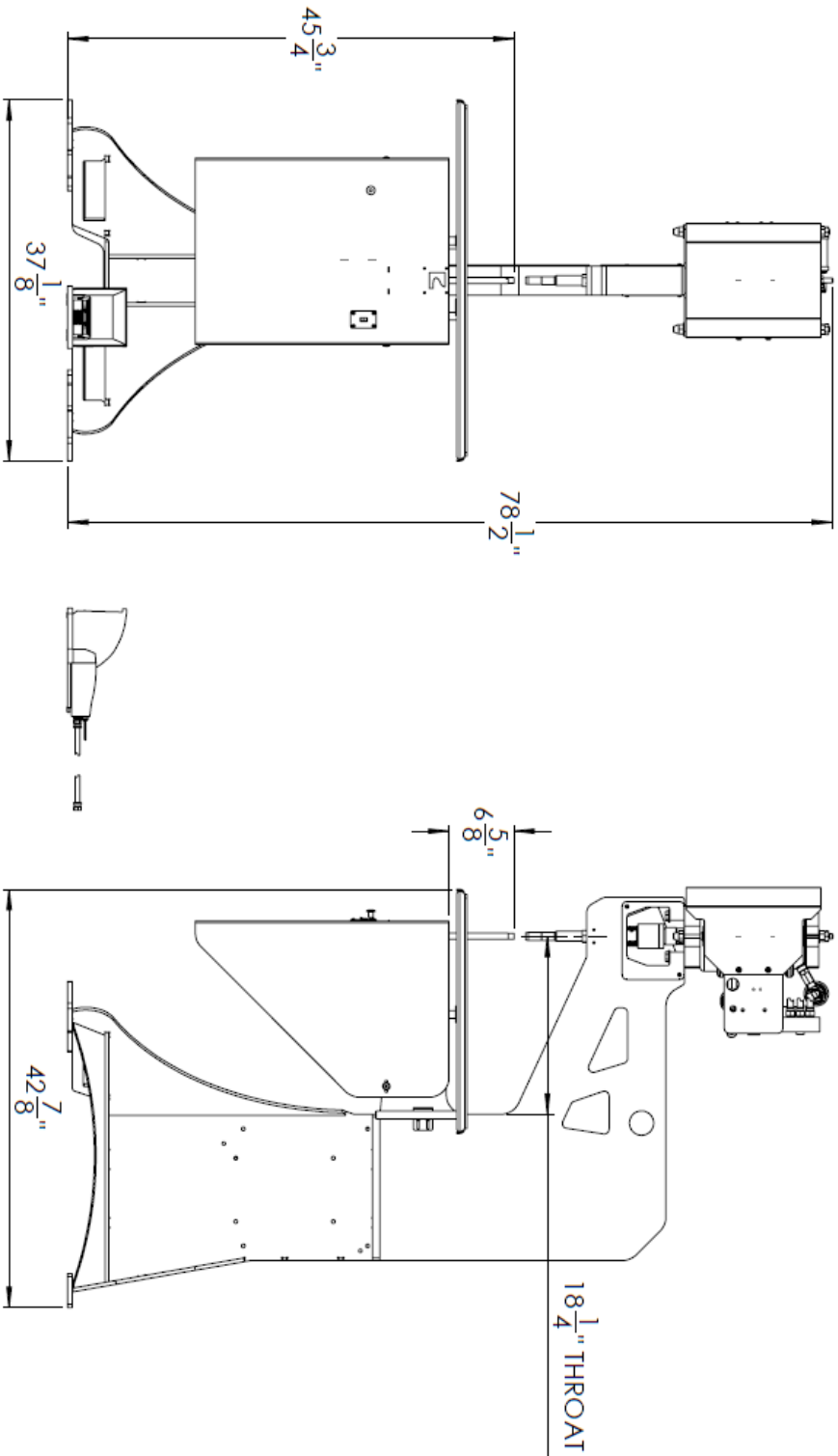

Material	Joined With	Net Max Thickness	Net Min Thickness
Aluminum	Clinch/SPR	0.160" / 4mm *	0.048" / 2.00mm
TPO	SPR	Contact Norlok	
Galvanized Steel	Clinch/SPR	0.120" / 3.8mm *	.030" / 0.50mm
Aluminum Composite	SPR	Contact Norlok	

* Self Piercing Rivets (SPR) are sold by Norlok. SPR can join thicker material and produce stronger bonds compared to clinch

Stroke: 1/4" [6.35mm] operating stroke. 6" [152.4mm] low pressure extend.

Throat: 18-1/4"[463.55mm]

Max Letter height: 6"[203.2mm]

Table: 24" x 36" [609.6mm x 914.4mm]

Cycle Speed: 60 - 80 CPM

Air Requirements: 70-100 psi [5-6.8 Bar], equipment consumes ~0.8 cu.ft of free air per cycle.