

THE LETTER LOK 'LITTLE LOK' 1200

The LetterLok 'LittleLok' 1200 fastening machine has been designed for fastening channel letters. It has a 12" throat and can accommodate a 6" return.

With the ability to fasten up to a 6" return and its ease of use the LittleLok 1200 can make short work of your channel letter fastening needs.

FEATURES:

- > machine can operate at 60 - 80 cycles per minute.
- > maximum combined material thickness of 0.125"
- > machine is 100% air powered
- > has an adjustable table to accommodate a 6" high letter.
- > UL recognized tooling. Norlok Technology Inc. in conjunction with the Letterlok series of machines produce a UL recognized clinch for Channel Letters.

THE LITTLELOK 1200 REPRESENTS THE NEXT GENERATION OF LETTERLOK MACHINES. WHETHER IT IS YOUR MAIN FASTENING MACHINE OR A SIBLING FOR AN EXISTING LETTERLOK THE LITTLELOK HAS THE FEATURES YOU NEED. YOU WILL HAVE THE PEACE OF MIND KNOWING YOU HAVE A MACHINE THAT WAS DESIGNED AND BUILT BY THE COMPANY THAT SETS THE STANDARD FOR THE CHANNEL LETTER INDUSTRY.

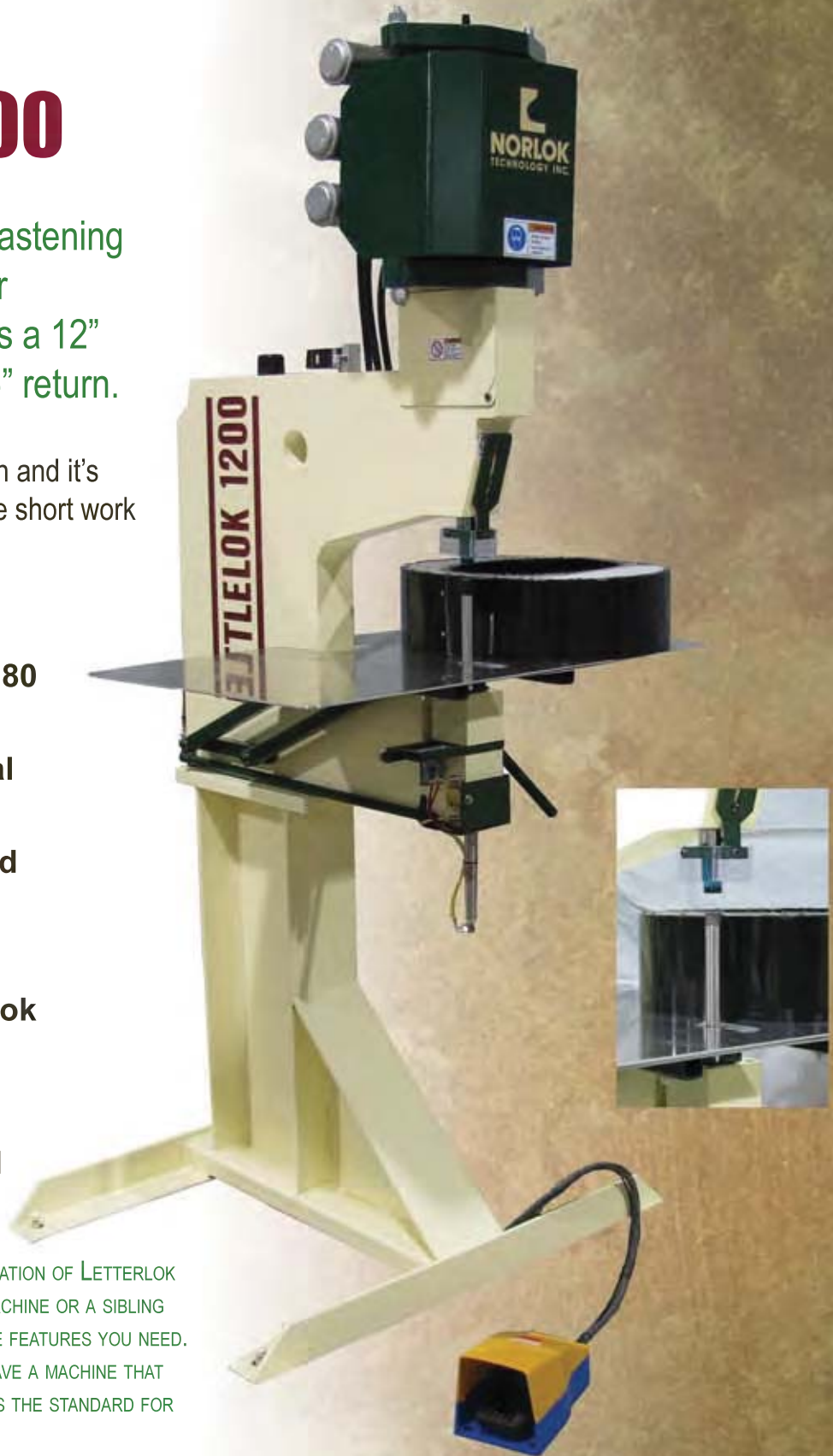

Norlok Technology Inc.
26 Adams Blvd., Brantford
Ontario, Canada, N3S 7V2
Ph: 519 759-5896 Fx: 519 759-2948
email: info@norlok.com web: www.norlok.com

SPECIFICATIONS – Letter Lok ‘LittleLok 1200
(Model – LT1200)

- Press Design:** 3" Solid steel "C" frame.
- Features:** WAMP pneumatic power unit.
Single shot auto return.
- Stroke:** 3 1/2" low pressure closing stroke
1/4"-3/8" high pressure clinching stroke
- Throat:** 12"
- Table:** 18" deep x 34" wide
- Work Height:** 44"
- Lower Tooling:** Die insert set in a hardened die holder.
- Upper Tooling:** Fast change punch
Replaceable punch stripper
Adjustable to suit material thickness.
- Capacity:** MAX: Combined thickness of 0.125".
MIN: Two ply 0.024" Aluminum.
MAX: Two ply 0.040" Mild Steel.
MIN: Two ply 0.015" Mild Steel.
- Cycle speed:** Clinching stroke 60 - 80 CPM.
100% duty cycle.
- Air Requirements:** 65 psi (operating)
125 psi (max supply) 80 psi (min)
Approx. 12-13 SCFM @ 65 PSI.
(80 clinches per minute)
- Dimensions:** Width 36" (overall)
Length 34" (overall)
Height 74" (overall)
Weight 700 lbs. (approx.)

Typical Joint Strengths (Aluminum):

Material Thickness Punch side / Die side	Pull	Peel
	Pull (lbs)	Peel (lbs)
0.063 to 0.063	240	72
0.063 to 0.040	270	50
0.040 to 0.040	175	60

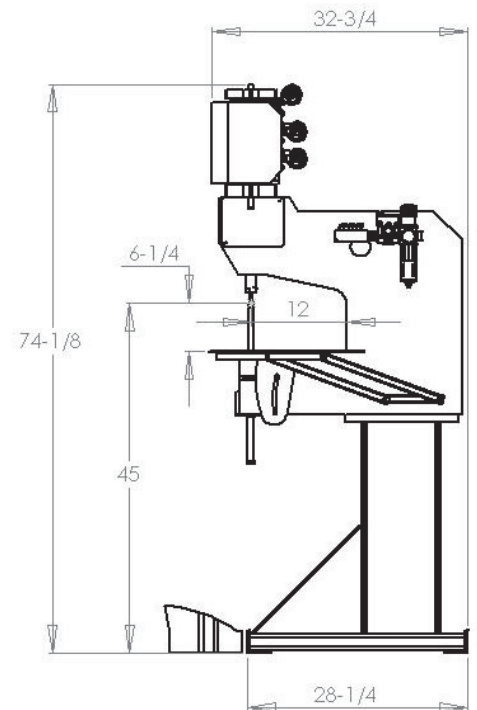
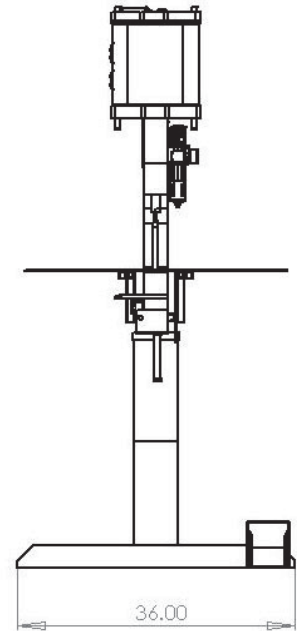
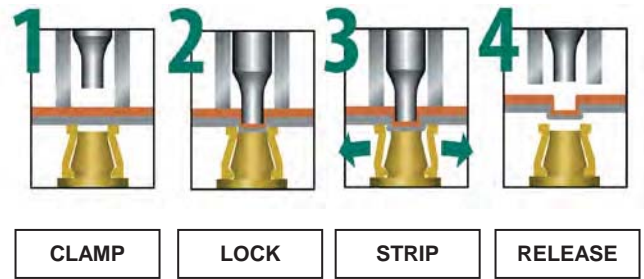

26 Adams Blvd, Brantford, ON,
Canada N3S 7V2
Ph 519.759.5896, Fx 519.759.2948
info@norlok.com www.norlok.com